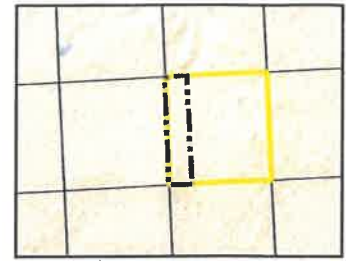

EXHIBIT "B"

PRELIMINARY ROUTE

MORTON COUNTY, NORTH DAKOTA



VICINITY MAP
N.T.S.

SEC. 6 135N 82W



ROUTING LENGTH = 1148.892 FT +/- / ACCESS ROAD LENGTH = 0 FT +/-

IMPACTS: PERMANENT EASEMENT = 5.275 AC. +/- / TEMPORARY CONSTRUCTION EASEMENT = 0 AC. +/- / EASEMENT WIDTH = 200 FT

Legend

- PROPOSED ROUTE
- - - ACCESS ROAD
- [] PARCEL BOUNDARY
- [] ADJACENT PROPERTIES
- STRUCTURE
- [] PERMANENT EASEMENT
- [] TEMPORARY WORKSPACE
- [] SECTION BOUNDARY
- [] COUNTY BOUNDARY

NOTES:

1. THIS IS A PRELIMINARY DOCUMENT AND IS INTENDED TO DEPICT THE APPROXIMATE LOCATION OF A PROPOSED TRANSMISSION EASEMENT.
2. THIS DOCUMENT DOES NOT REPRESENT A LAND SURVEY AND IS NOT INTENDED TO DEPICT THE FINAL ALIGNMENT
3. COORDINATE SYSTEM: UTM ZONE 13 NORTH, NAD83, US SURVEY FEET
4. NOT FOR RECORDING PURPOSES

D.F. 1-3-23
V.E. 1-3-23

PRELIMINARY TRANSMISSION ROUTE

DRAWN BY: TRC		GRID UNITED NORTH PLAINS CONNECTOR VALENTINE FLECK TAX ID: 110027000 TRACT NUMBER: SPP-ND-MR-0014.000
CHECKED BY: TRC		
MAP DATE: 10/11/2022		
SCALE: 1 inch = 1,300'		
REV NO.	DATE	DESCRIPTION
A	7/28/2022	INITIAL ISSUE
B	10/11/2022	UPDATE SKETCH NOTES
DRAWING NO. C-NPC-ACQ-SPP-ND-MR-0014.000		PROJECT NO. 485654
		SHEET NO. 01 of 01

EXHIBIT "B"

PRELIMINARY ROUTE

MORTON COUNTY, NORTH DAKOTA

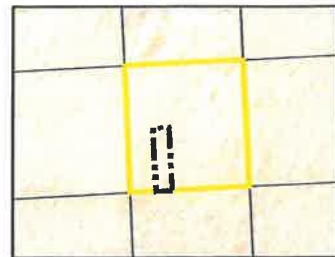

VICINITY MAP
N.T.S.

SEC. 6 135N 82W



ROUTING LENGTH = 680.867 FT +/- / ACCESS ROAD LENGTH = 0 FT +/-

IMPACTS: PERMANENT EASEMENT = 3.034 AC. +/- / TEMPORARY CONSTRUCTION EASEMENT = 0 AC. +/- / EASEMENT WIDTH = 200 FT

Legend

- PROPOSED ROUTE
- - - ACCESS ROAD
- PARCEL BOUNDARY
- ADJACENT PROPERTIES
- STRUCTURE
- PERMANENT EASEMENT
- ▨ TEMPORARY WORKSPACE
- SECTION BOUNDARY
- COUNTY BOUNDARY

NOTES:

1. THIS IS A PRELIMINARY DOCUMENT AND IS INTENDED TO DEPICT THE APPROXIMATE LOCATION OF A PROPOSED TRANSMISSION EASEMENT.
2. THIS DOCUMENT DOES NOT REPRESENT A LAND SURVEY AND IS NOT INTENDED TO DEPICT THE FINAL ALIGNMENT
3. COORDINATE SYSTEM: UTM ZONE 13 NORTH, NAD83, US SURVEY FEET
4. NOT FOR RECORDING PURPOSES

D. F. 1-3-23
V. A. 1-3-23

PRELIMINARY TRANSMISSION ROUTE

DRAWN BY: TRC

CHECKED BY: TRC

MAP DATE: 10/11/2022

SCALE: 1 inch = 650'

GRID UNITED
NORTH PLAINS CONNECTOR
VALENTINE FLECK

TAX ID: 110026000
TRACT NUMBER: SPP-ND-MR-0015.000

REV NO.	DATE	DESCRIPTION
A	7/28/2022	INITIAL ISSUE
B	10/11/2022	UPDATE SKETCH NOTES

DRAWING NO.
C-NPC-ACQ-SPP-ND-MR-0015.000

PROJECT NO.
485654

SHEET NO.
01 of 01

EXHIBIT "B"

PRELIMINARY ROUTE

MORTON COUNTY, NORTH DAKOTA

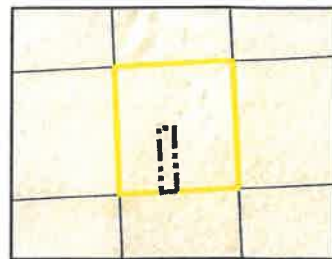

VICINITY MAP
N.T.S.

SEC. 6 135N 82W



ROUTING LENGTH = 660.721 FT +/- / ACCESS ROAD LENGTH = 0 FT +/-

IMPACTS: PERMANENT EASEMENT = 3.034 AC. +/- / TEMPORARY CONSTRUCTION EASEMENT = 0 AC. +/- / EASEMENT WIDTH = 200 FT

Legend

- PROPOSED ROUTE
- - - ACCESS ROAD
- ▭ PARCEL BOUNDARY
- ▭ ADJACENT PROPERTIES
- STRUCTURE
- PERMANENT EASEMENT
- ▨ TEMPORARY WORKSPACE
- ▭ SECTION BOUNDARY
- ▭ COUNTY BOUNDARY

NOTES:

1. THIS IS A PRELIMINARY DOCUMENT AND IS INTENDED TO DEPICT THE APPROXIMATE LOCATION OF A PROPOSED TRANSMISSION EASEMENT.
2. THIS DOCUMENT DOES NOT REPRESENT A LAND SURVEY AND IS NOT INTENDED TO DEPICT THE FINAL ALIGNMENT
3. COORDINATE SYSTEM: UTM ZONE 13 NORTH, NAD83, US SURVEY FEET
4. NOT FOR RECORDING PURPOSES

D. F. 1-3-23
V. F. 1-3-23

PRELIMINARY TRANSMISSION ROUTE

DRAWN BY: TRC

CHECKED BY: TRC

MAP DATE: 10/11/2022

SCALE: 1 inch = 650'

GRID UNITED
NORTH PLAINS CONNECTOR
VALENTINE FLECK

TAX ID: 110025000
TRACT NUMBER: SPP-ND-MR-0016.000

REV NO.	DATE	DESCRIPTION
A	7/28/2022	INITIAL ISSUE
B	10/11/2022	UPDATE SKETCH NOTES

DRAWING NO.
C-NPC-ACQ-SPP-ND-MR-0016.000

PROJECT NO.
485654

SHEET NO.
01 of 01